

3RS Rail-Road Shunter

RAFAMET 3RS Rail-Road Shunter is designed for shunting / manoeuvring the rolling stock of maximum total mass up to 350 tonnes. The shunter moves on rails and flat surfaces of e.g. production workshops, manoeuvring areas, loading platforms within enclosed industrial facilities (railways, metro, tram depot, ports etc.). The 3RS Shunter can be also used as auxiliary equipment for Underfloor Wheel Lathe.



Rail-Road Shunter



- Versatile applications thanks to rail and road drivability
- Excellent manoeuvrability thanks to four independently driven wheels rotating around their axes
- Easy control by means of portable panel (radio remote control)
- Vented, robust lead acid battery with electrolyte refill
- Two adapter plate for couplers or two couplers (type to be agreed upon)
- Emission-free operations

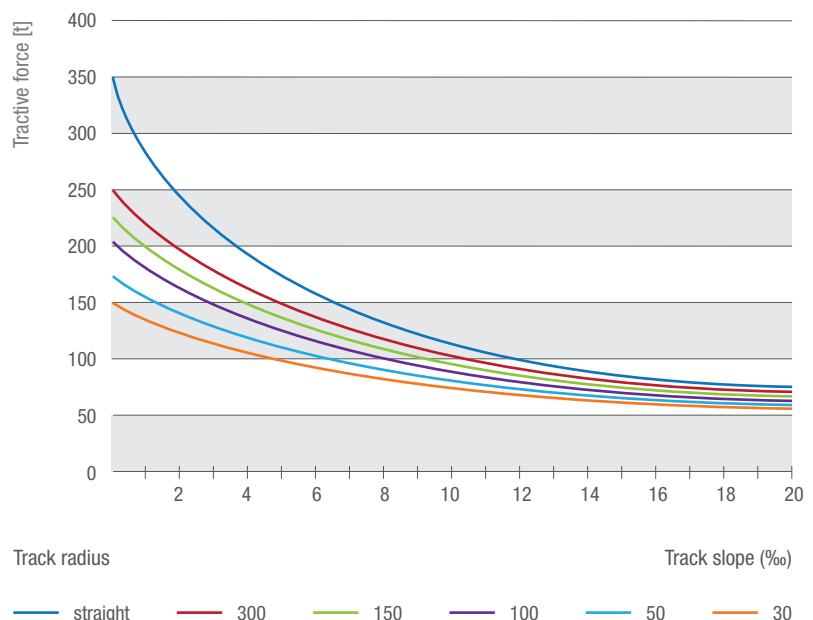
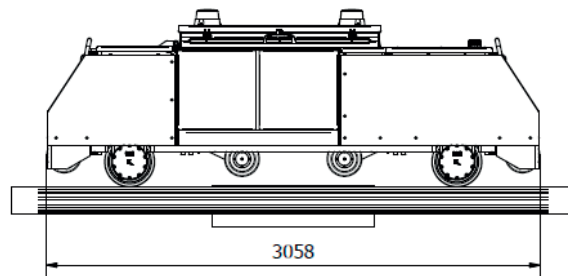
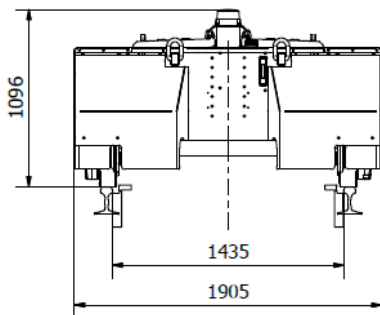

Fig. RAFAMET 3RS 350 Shunter. Towed weight in function of track slope and track radius

TECHNICAL SPECIFICATIONS	3RS
Capacities	
Track gauge	1435 mm (another to be agreed upon)
Min. turning radius	30 m
Tractive force	Min. 17.5 kN
Max. weight to shunt in normal conditions (dry, straight and flat track)	350 tonnes
Max. speed on road	6 kmph
Max. speed on rails without load	6 kmph
Max. speed on rails with load	2 kmph
Drive system	
Number of guiding / driving wheels	4 + 4 / 4 pcs
Turning drive	4 (*) / 2 electric servo-motors and gears
Turning directions	Curves and diagonals (*) / Curves
Power of electric drive motors	4 × 5 kW
Battery	
Type	Vented, robust lead acid battery with liquid electrolyte
Rated voltage	80 V
Capacity	320 Ah
Recharging cycles	Min. 1200
Overall dimensions	
L / W / H (without couplers, without operator's cab)	3058 / 1905 / 1096 mm
H (without couplers, with operator's cab)	2700 mm
Approximate weight	5 tonnes



(*) – Not available in Austria, France, Germany, Great Britain, Japan, the Netherlands, Switzerland, USA.